

REV	DATE	MODIFICATION	DRAWN
	2010/09/14		

SPECIFICATIONS
 1.ELECTRICAL:
 UL APPLICATIONS: 250 VOLTS AC MAX.; AT 2 AMPS.
 DIELECTRIC WITHSTANDING VOLTAGE : 1000 VOLTS AC.
 WITHSTAND VOLTAGE TIME: 60S.
 INSULATION RESISTANCE: 100M Ω.
 TERMINATION: RESISTANCE 20m Ω MAX AFTER ENVIRONMENTAL TESTING.

2.MECHANICAL:
 CABLE-TO-PLUG TENSILE STRENGTH : 20POUND MIN.
 DURABILITY : 200 MATING CYCLES.

3.MATERIAL & FINISH:
 HOUSING: POLYCARBONATE, UL94V-0 OR UL94V-2.
 COLOR : TRANSPARENT OR OTHER COLOR ARE AVAILABLE.
 CONTACT BLADE: COPPER ALLOY.
 CONDUCTOR : STRANDED & SOLID WIRE, 24AWG, 26 AWG.
 (It can be used for the wire OD fromØ 0.96-Ø1.02)
 GOLD PLATING: 3u"-50u", ARE AVAILABLE.
 SHIELDED SHELL: COPPER ALLOY.

1.电器:

UL应用最大250VOLTS AC.
 介质耐电压伏特数:1000VOLTS AC.
 耐压时间:60S.

绝缘阻抗:100百万欧姆.
 终端阻抗:在环境测试后最大可承受20微欧姆终端阻抗.

2.机构

拉力测试:至少20磅.
 耐力测试:至少200次之插拔测试.

3.材质表面处理

塑胶壳:聚碳酸酯,UL-94V-0 or UL-94V-2.
 颜色:透明,或者其他颜色亦可.
 金片:铜合金.
 导体:多股线&单股线,24AWG,26AWG.
 (芯线直径:Ø0.96-Ø1.02均可适用)
 镀金厚度:3u"~50u",皆可提供.
 铜外壳:铜合金.

客户用产品图

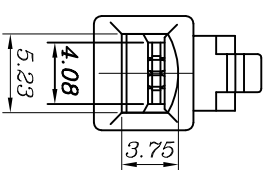
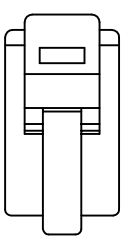
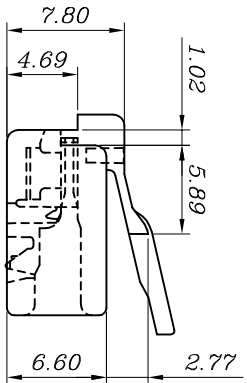
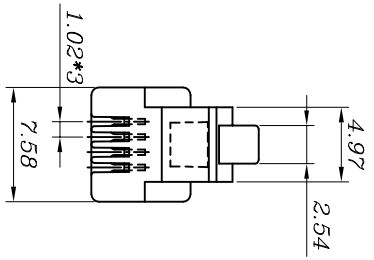

Round

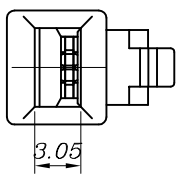

Flat

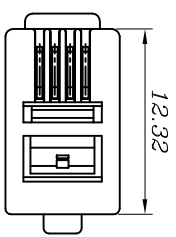

BLADE:	E	EB	Y	YB	Z	A	AE	AB	EC	AL	ZL	YBL
Drawing												
Mark	✓											
GOLD PLATING	3Mu"	3u"	6u"	15u"	30u"	50u"						
Mark						✓						
							CABLE TYPE	ROUND	FLAT			
							Mark			✓		



宁波卓新通讯插件有限公司
 NINGBO EXCELLENCE COMMUNICATED CONNECTOR CO.,LTD

DIMENSION IN mm (Inch)	材 质	图 号
TOLERANCE UNLESS OTHERWISE SPECIFIED	MATERIAL	DWG NO.
.X±0.20	PC	PLUG-001-0004
.XX±0.10		
.X°±5°	名称	P42FE50V2
.XX°±2°	TITLE	

审核	核对	制图	比例	张数
沈红波	钟均江	LiWenjuan	2/1	1/1
Approval	Checked	Drawn	Scale	Sheet
			角法	更改
			Proj.	REV
				A

A B C D

1 2 3 4 5 6 7

1 2 3 4 5 6 7

1 2 3 4 5 6 7

1 2 3 4 5 6 7

1 2 3 4 5 6 7

1 2 3 4 5 6 7

1 2 3 4 5 6 7

1 2 3 4 5 6 7

1 2 3 4 5 6 7

1 2 3 4 5 6 7

1 2 3 4 5 6 7

1 2 3 4 5 6 7

1 2 3 4 5 6 7

1 2 3 4 5 6 7

1 2 3 4 5 6 7

1 2 3 4 5 6 7

1 2 3 4 5 6 7

1 2 3 4 5 6 7

1 2 3 4 5 6 7

1 2 3 4 5 6 7

1 2 3 4 5 6 7

1 2 3 4 5 6 7

1 2 3 4 5 6 7

1 2 3 4 5 6 7

1 2 3 4 5 6 7

1 2 3 4 5 6 7

1 2 3 4 5 6 7

1 2 3 4 5 6 7

1 2 3 4 5 6 7

1 2 3 4 5 6 7

1 2 3 4 5 6 7

1 2 3 4 5 6 7